

ES-RT-Z4-CCT

Tunable White Touch Wheel
RF Remote Controller



ES-RT-Z4-CCT

Tunable White Touch Wheel RF Remote Controller



Features

- 4 independent zones
- Controls multiple EnoSync CCT controllers
- Touch wheel for smooth CCT adjustment
- Direct warm white and cool white buttons
- Full brightness control with 10–256 step adjustment
- Scene recall and save (S1–S4)
- AAx2 battery powered
- 30m RF range
- LED indicator feedback



Electrical Specifications

Specifications	Description
Output Signal:	RF(2.4GHz)
Working Voltage:	3VDC(AAAx2)
Working Current:	<5mA
Standby Current:	<10μA
Standby Time:	1 year
Remote Distance:	30m (Barrier-free space)
Operation Temperature:	-30°C ~ +55°C/-22°F ~ +131°F
Dimensions (W x H x L):	2.08" x 0.68" x 4.8"
Gross Weight:	0.088kg
Warranty:	5 years
EMC Standard:	EN IEC 55015/EN IEC 61547 ETSI EN 301 489-1/-3
Safety Standard:	EN 61347-1/-2 EN 62493
Radio Equipment:	ETSI EN 300 440
Certification:	CE RoHS FCC UL

Mechanical Specifications

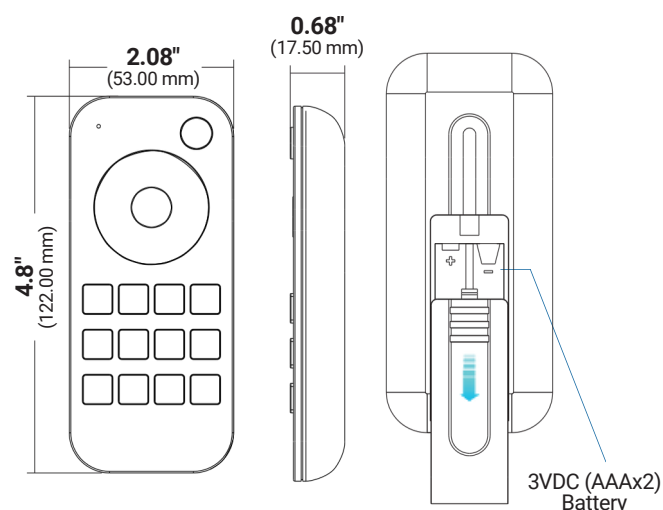

ES-RT-Z4-CCT

Tunable White Touch Wheel RF Remote Controller



Back Holder

Two options are offered for selection, please fix the back holder on the wall with two screws, or adhere the back holder to the wall with plaster.

1. Back holder without magnet

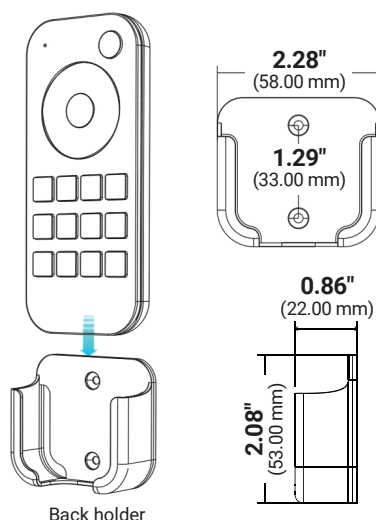

2. Back holder with magnet (The remote with built-in magnet)

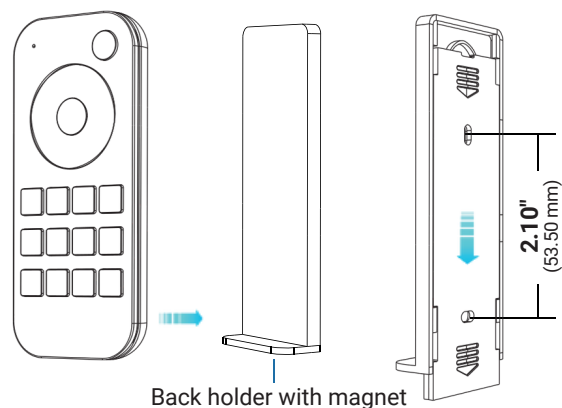

Operation

- When turn on light, the indicator display blue. when turn off light, the indicator display red.
- When touch the color wheel, the indicator will display the same color.
- When press or touch operation is invalid (If the light is off), the indicator display red.
- To extend battery life, no touch or press key operation after a few seconds, the touch wheel will enter sleep state, you need press any key to make touch wheel quit sleep state.

ES-RT-Z4-CCT

Tunable White Touch Wheel RF Remote Controller



Key Function

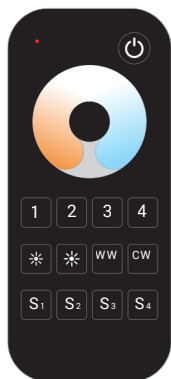

: Short press turn on/off all zone light.

: Touch to change current zone color temperature.

: Short press select and turn on zone light, long press 2s turn off zone light.
Short press multiple zone key fastly, will select multiple zone synchronously.

: Adjust brightness for current selected zone, short press 10 levels, long press 1-6s for continuous 256 levels adjustment.

: Get warm white or cold white directly for current selected zone.

: Short press recall the scene, long press 2s save current state into S1/2/3/4.
The LED indicator display green when save OK.
4 zone recall or save synchronously.